

## 2,052- 6,804 SF Office Space



## 800 S. 7th Avenue

Sioux Falls, SD 57104

### Property Features

- Suite A: 2,052 sq. ft.
- Suite B: 4,760 sq. ft.
- Combined: 6,804 sq. ft.
- Available immediately
- Paved parking: 23 spaces
- Monument & suite signage
- Zoning: I-1
- Year built: 1946
- Outdoor storage available for additional rate - negotiable

### Pricing

- Price reduced: \$9.50/sq. ft. gross plus utilities
- Xcel budget: \$625/ month
- Gas budget: \$194/ month
- Water/sewer budget: \$150/ month

### Location

- Located southwest of the Cliff Avenue and 14th Street intersection
- Area neighbors include: BP Get n' Go, Sioux Falls Federal Credit Union, Hagen Chiropractic, The Fire Emporium Inc., Avera Health

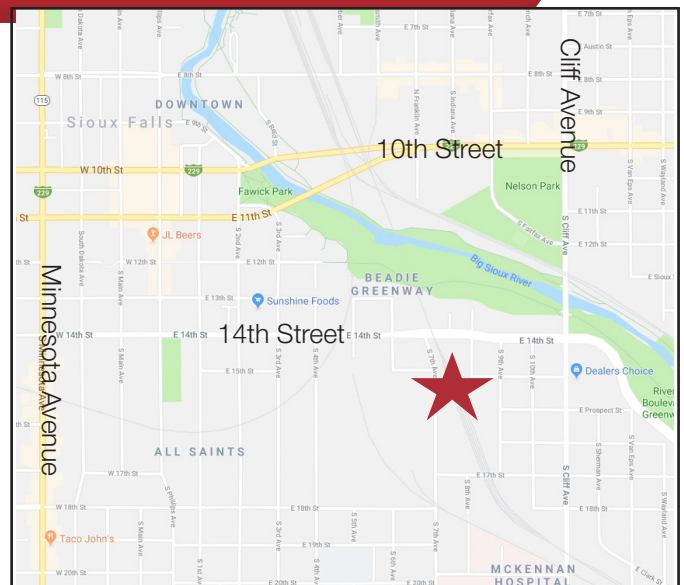

For more information:

**Troy Fawcett, CCIM, SIOR**  
President

605 321 2199 • [tfawcett@naisiouxfalls.com](mailto:tfawcett@naisiouxfalls.com)

2500 W. 49th Street Suite 100  
Sioux Falls, SD 57105  
+1 605 357 7100  
[naisiouxfalls.com](http://naisiouxfalls.com)

NO WARRANTY OR REPRESENTATION, EXPRESS OR IMPLIED, IS MADE AS TO THE ACCURACY OF THE INFORMATION CONTAINED HEREIN, AND THE SAME IS SUBMITTED SUBJECT TO ERRORS, OMISSIONS, CHANGE OF PRICE, RENTAL OR OTHER CONDITIONS, PRIOR SALE, LEASE OR FINANCING, OR WITHDRAWAL WITHOUT NOTICE, AND OF ANY SPECIAL LISTING CONDITIONS IMPOSED BY OUR PRINCIPALS NO WARRANTIES OR REPRESENTATIONS ARE MADE AS TO THE CONDITION OF THE PROPERTY OR ANY HAZARDS CONTAINED THEREIN ARE ANY TO BE IMPLIED.

# FOR LEASE

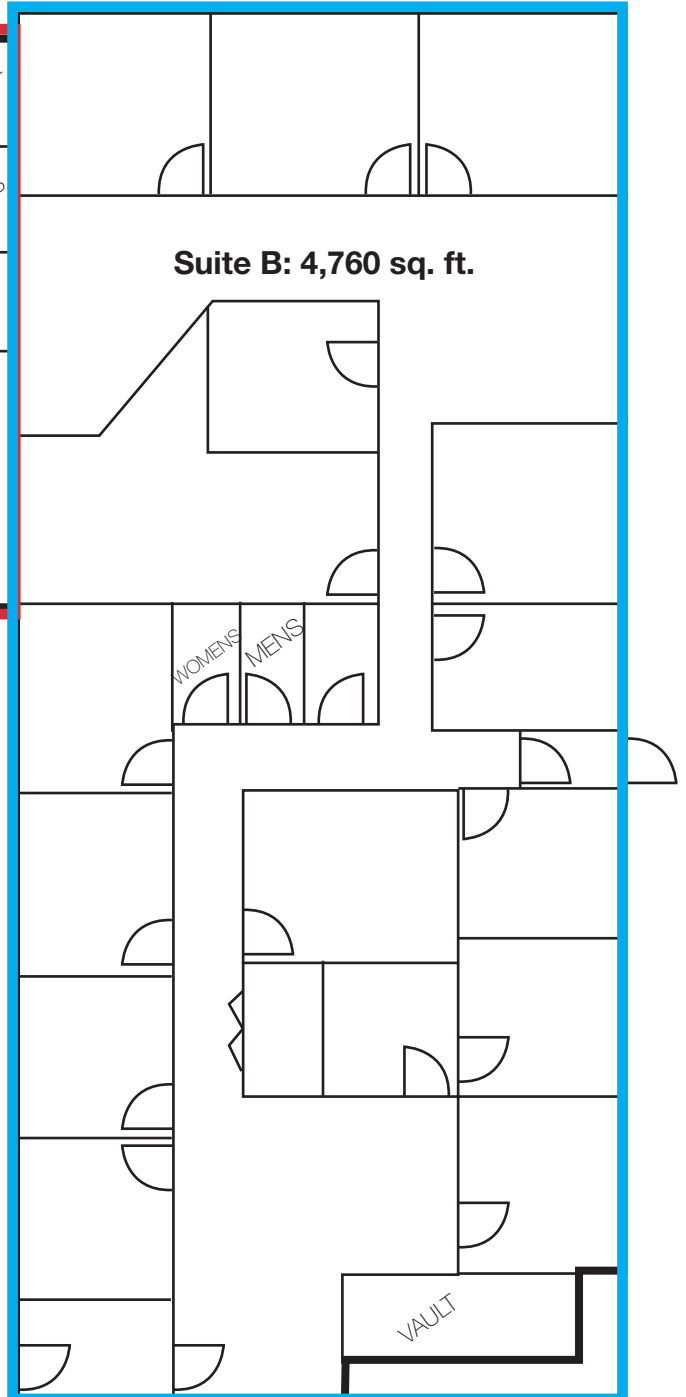
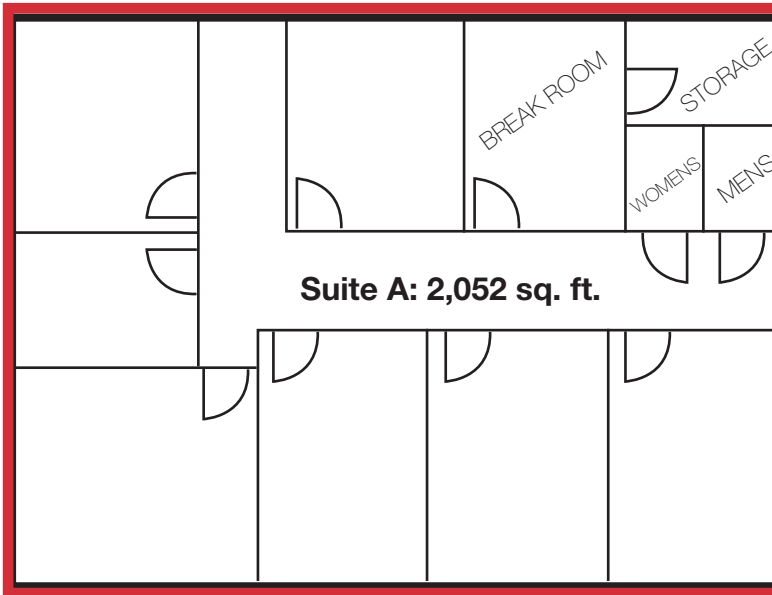

7TH AVENUE

**NAI** Sioux Falls

2500 W. 49th Street Suite 100  
Sioux Falls, SD 57105  
+1 605 357 7100  
naisiouxfalls.com

# FOR LEASE

