

# DC 290

18140 Kickapoo Road | Waller, TX 77484



## INVESTMENT OPPORTUNITY ±478,400 Sq. Ft. Cross-Dock Distribution Building



STEPHEN SCHNEIDAU  
(713) 963 2822  
[Stephen.Schneidau@cushwake.com](mailto:Stephen.Schneidau@cushwake.com)

JIM FOREMAN  
(713) 963 2824  
[Jim.Foremand@cushwake.com](mailto:Jim.Foremand@cushwake.com)

BEAU KALEEL, SIOR  
(713) 963 2844  
[Beau.Kaleel@cushwake.com](mailto:Beau.Kaleel@cushwake.com)

ALLISON BERGMANN  
(713) 963 2865  
[Allison.Bergmann@cushwake.com](mailto:Allison.Bergmann@cushwake.com)

MICHAEL FOREMAN  
(713) 963 2850  
[Michael.Foreman@cushwake.com](mailto:Michael.Foreman@cushwake.com)



# DC 290

18140 Kickapoo Road | Waller, TX 77484



<b>Total Rentable Area</b>	478,400 SF
<b>Site Area</b>	44.54 Acres
<b>% Leased</b>	34.8% Leased
<b>Building Depth</b>	400'
<b>Truck Court</b>	120' (expandable)
<b>Clear Height</b>	32'
<b>Column Spacing</b>	46' X 52'

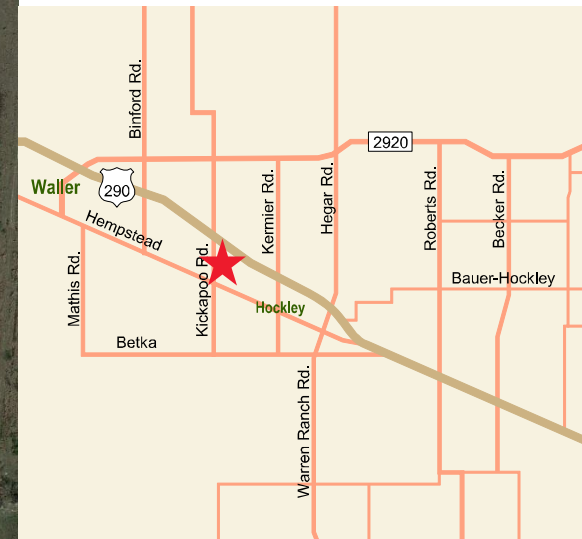

STEPHEN SCHNEIDAU  
(713) 963 2822  
[Stephen.Schneidau@cushwake.com](mailto:Stephen.Schneidau@cushwake.com)

JIM FOREMAN  
(713) 963 2824  
[Jim.Foreman@cushwake.com](mailto:Jim.Foreman@cushwake.com)

BEAU KALEEL, SIOR  
(713) 963 2844  
[Beau.Kaleel@cushwake.com](mailto:Beau.Kaleel@cushwake.com)

ALLISON BERGMANN  
(713) 963 2865  
[Allison.Bergmann@cushwake.com](mailto:Allison.Bergmann@cushwake.com)

MICHAEL FOREMAN  
(713) 963 2850  
[Michael.Foreman@cushwake.com](mailto:Michael.Foreman@cushwake.com)

# DC 290

18140 Kickapoo Road | Waller, TX 77484



## PROPERTY INFORMATION

- ±478,400 sq. ft. building with up to 312,000 sq. ft. available
- 34.7% leased
- Dock-high, cross-dock distribution space
- ±44.54 acre site
- New construction
- 32' clear height
- 120' truck courts
- Ample parking
- Trailer storage available
- Excellent visibility and access to US 290
- ESFR sprinkler system
- 400 amp power
- 400' building depth
- 46' X 52' column spacing with 60' speed bays
- Can be subdivided - Minimum lease size: 120,000 sq. ft.

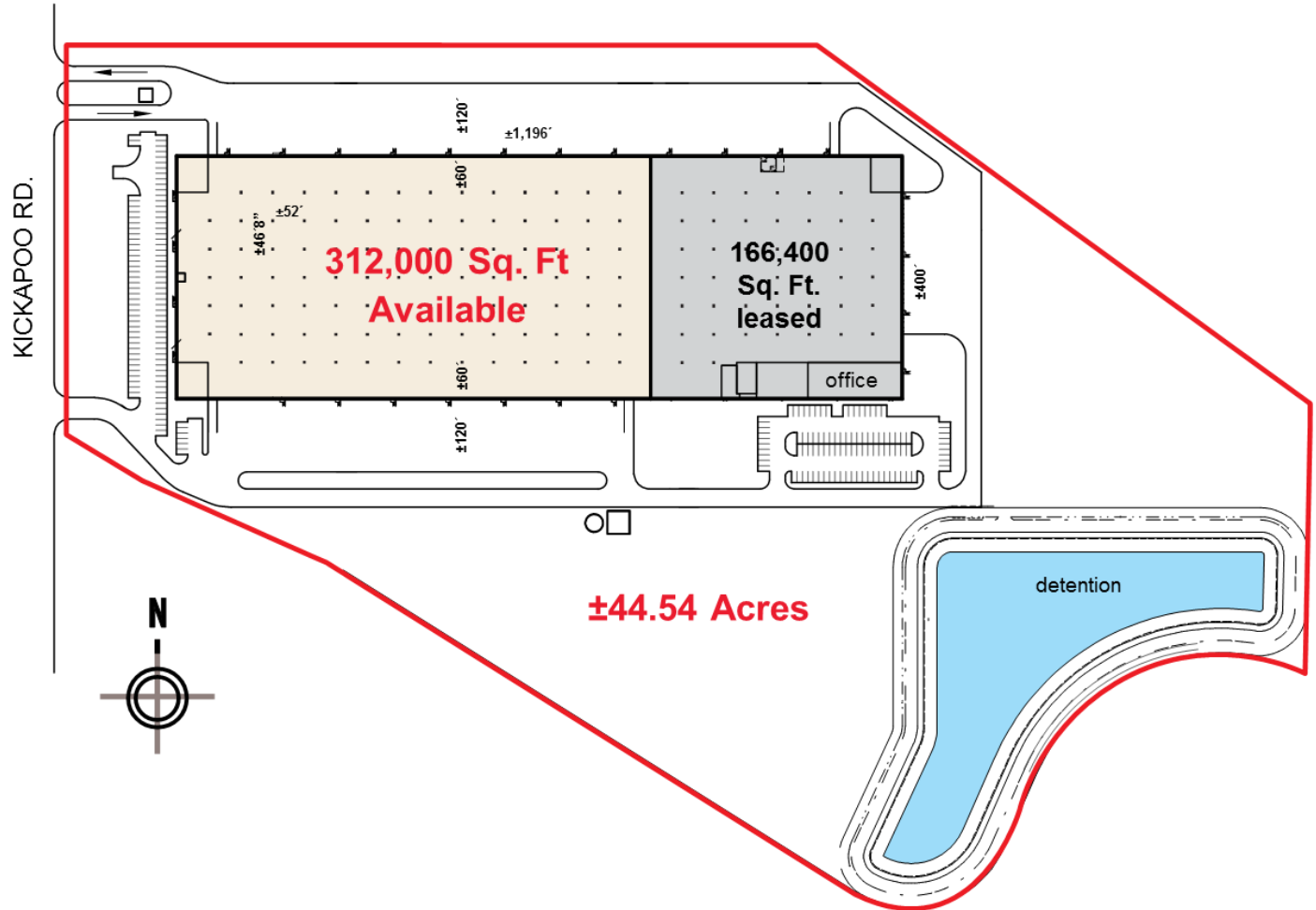

STEPHEN SCHNEIDAU  
(713) 963 2822  
[Stephen.Schneidau@cushwake.com](mailto:Stephen.Schneidau@cushwake.com)

JIM FOREMAN  
(713) 963 2824  
[Jim.Foreman@cushwake.com](mailto:Jim.Foreman@cushwake.com)

BEAU KALEEL, SIOR  
(713) 963 2844  
[Beau.Kaleel@cushwake.com](mailto:Beau.Kaleel@cushwake.com)

ALLISON BERGMANN  
(713) 963 2865  
[Allison.Bergmann@cushwake.com](mailto:Allison.Bergmann@cushwake.com)

MICHAEL FOREMAN  
(713) 963 2850  
[Michael.Foreman@cushwake.com](mailto:Michael.Foreman@cushwake.com)



# DC 290

18140 Kickapoo Road | Waller, TX 77484



STEPHEN SCHNEIDAU  
(713) 963 2822  
[Stephen.Schneidau@cushwake.com](mailto:Stephen.Schneidau@cushwake.com)

JIM FOREMAN  
(713) 963 2824  
[Jim.Foremand@cushwake.com](mailto:Jim.Foremand@cushwake.com)

BEAU KALEEL, SIOR  
(713) 963 2844  
[Beau.Kaleel@cushwake.com](mailto:Beau.Kaleel@cushwake.com)

ALLISON BERGMANN  
(713) 963 2865  
[Allison.Bergmann@cushwake.com](mailto:Allison.Bergmann@cushwake.com)

MICHAEL FOREMAN  
(713) 963 2850  
[Michael.Foreman@cushwake.com](mailto:Michael.Foreman@cushwake.com)