

3251 Fox Street

Philadelphia, PA 19129

\$12/SF NNN

2,219 SF - 4,146 SF Available

Property Highlights

- Private, off-street parking available
- Shared tenant drive-in loading dock
- Fully sprinklered building

Loft-Style
Office/Retail
Space

Availabilities

- 2,219 SF
- 4,146 SF
- 2,300 SF

For more information:

Karl Schwemlein
karls@geisrealty.com

United Plaza, 30 South 17th Street, Suite 810, Philadelphia, PA 19103

215 568 7222 (Office)

215 253 5530 (Direct)

NAI Geis Realty
Group, Inc.

NO WARRANTY OR REPRESENTATION, EXPRESS OR IMPLIED, IS MADE AS TO THE ACCURACY OF THE INFORMATION CONTAINED HEREIN, AND THE SAME IS SUBMITTED SUBJECT TO ERRORS, OMISSIONS, CHANGE OF PRICE, RENTAL OR OTHER CONDITIONS, PRIOR SALE, LEASE OR FINANCING, OR WITHDRAWAL WITHOUT NOTICE, AND OF ANY SPECIAL LISTING CONDITIONS IMPOSED BY OUR PRINCIPALS NO WARRANTIES OR REPRESENTATIONS ARE MADE AS TO THE CONDITION OF THE PROPERTY OR ANY HAZARDS CONTAINED THEREIN ARE ANY TO BE IMPLIED.

1st Floor

- 2,219 SF - Plumbing hookups throughout
- 4,146 SF - Direct suite entrance off West Moreland Street

2nd Floor (not shown)

- 2,300 SF - 3 sides of windows, abundant natural light

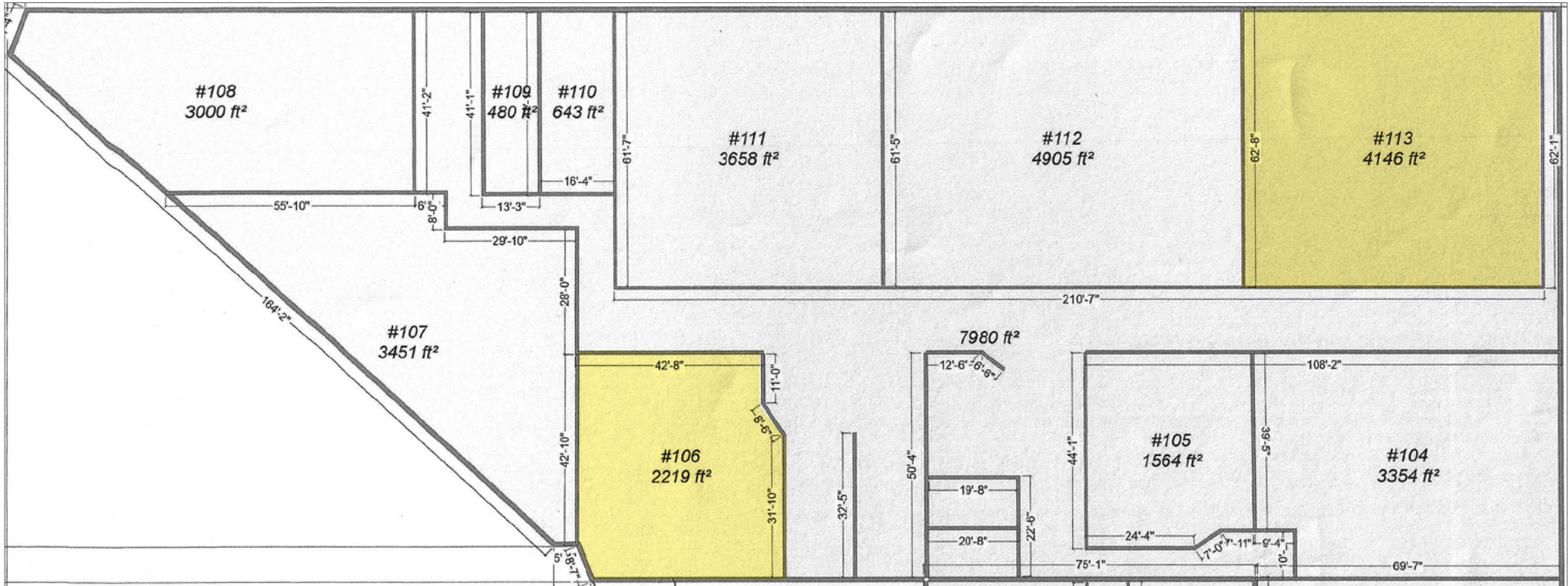

For more information:

Karl Schwemlein
karls@geisrealty.com

United Plaza, 30 South 17th Street, Suite 810, Philadelphia, PA 19103

215 568 7222 (Office)

215 253 5530 (Direct)





For more information:

Karl Schwemlein
karls@geisrealty.com

United Plaza, 30 South 17th Street, Suite 810, Philadelphia, PA 19103

215 568 7222 (Office)

215 253 5530 (Direct)



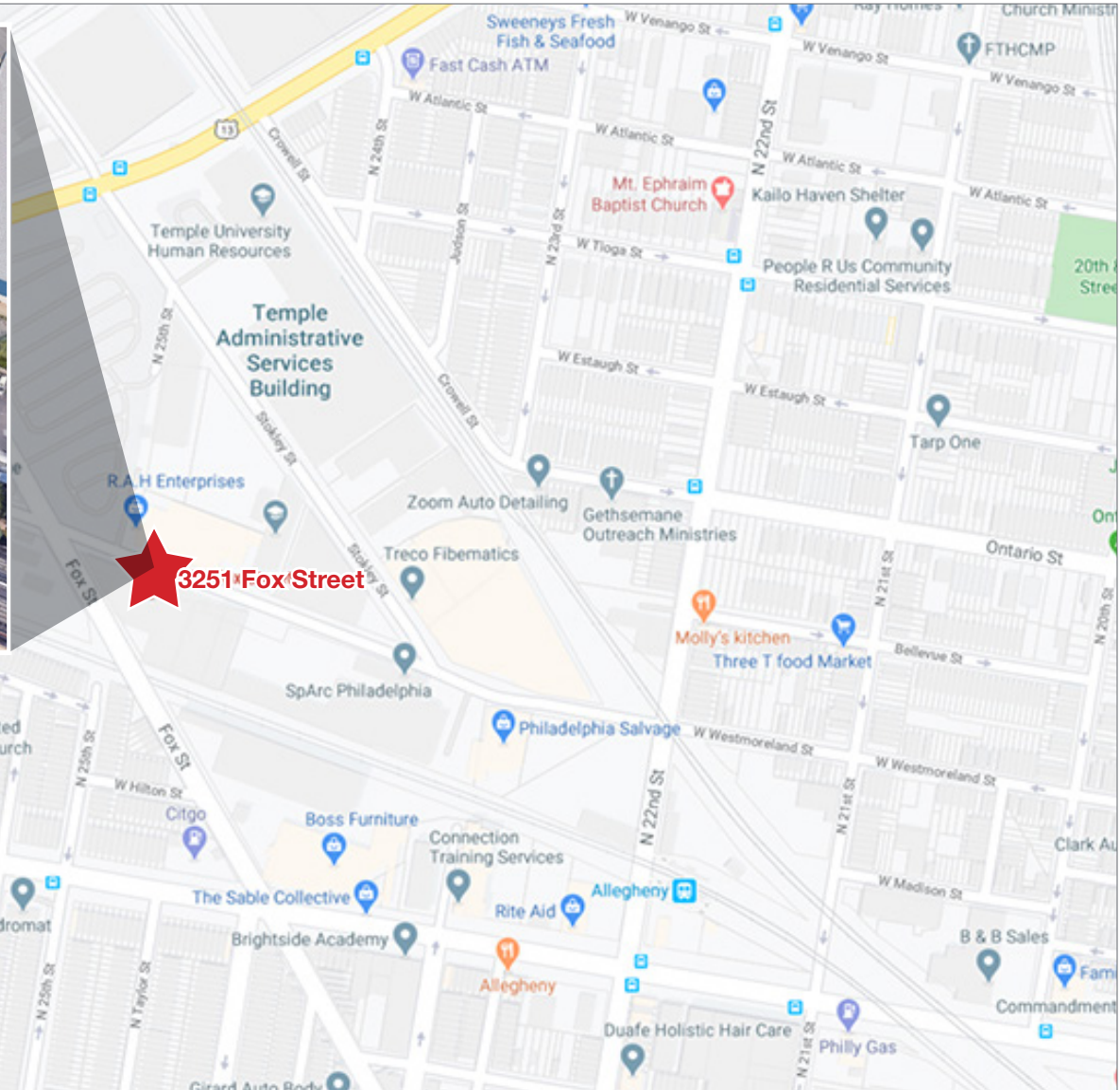
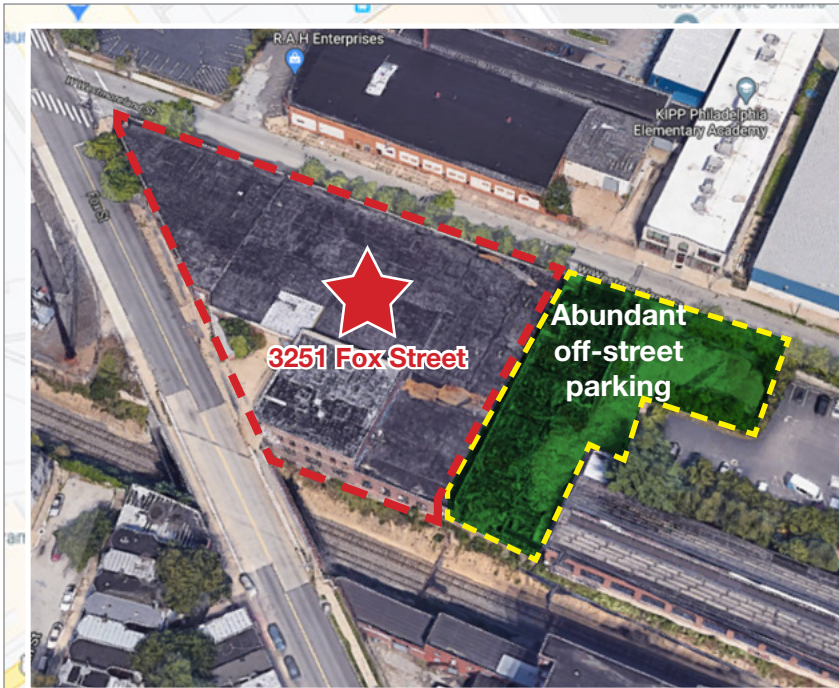

For more information:

Karl Schwemlein
karls@geisrealty.com

United Plaza, 30 South 17th Street, Suite 810, Philadelphia, PA 19103

215 568 7222 (Office)

215 253 5530 (Direct)

