



# For Lease

**6287 DOYLE STREET  
EMERYVILLE, CA**

## Area

±3,562 square feet

## Rental Rate

\$1.75/SF IG (CAM approximately \$0.05)

## Possession

Immediately

## Property Highlights

- Grade Level Truck Door on Doyle Street
- Sprinklered
- New Paint
- ±14-15' Clear Height
- ADA Restroom
- Walking Distance to Restaurants
- Tenant Improvements Available

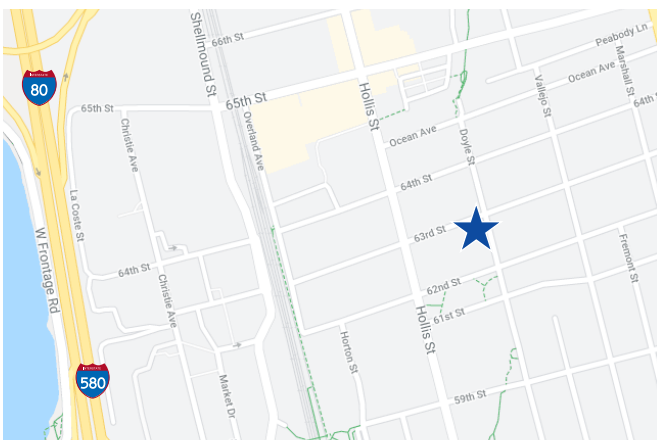

*For information, please contact:*

### Jim Clark

Senior Managing Director

t 510-923-6247

jim.clark@ngkf.com

CA RE Lic #00926308

### Jeff Lahr

Managing Director

t 510-923-6208

jlahr@ngkf.com

CA RE Lic #01296493

[nmrk.com](http://nmrk.com)

**NEWMARK**

The distributor of this communication is performing acts for which a real estate license is required. The information contained herein has been obtained from sources deemed reliable but has not been verified and no guarantee, warranty or representation, either express or implied, is made with respect to such information. Terms of sale or lease and availability are subject to change or withdrawal without notice.

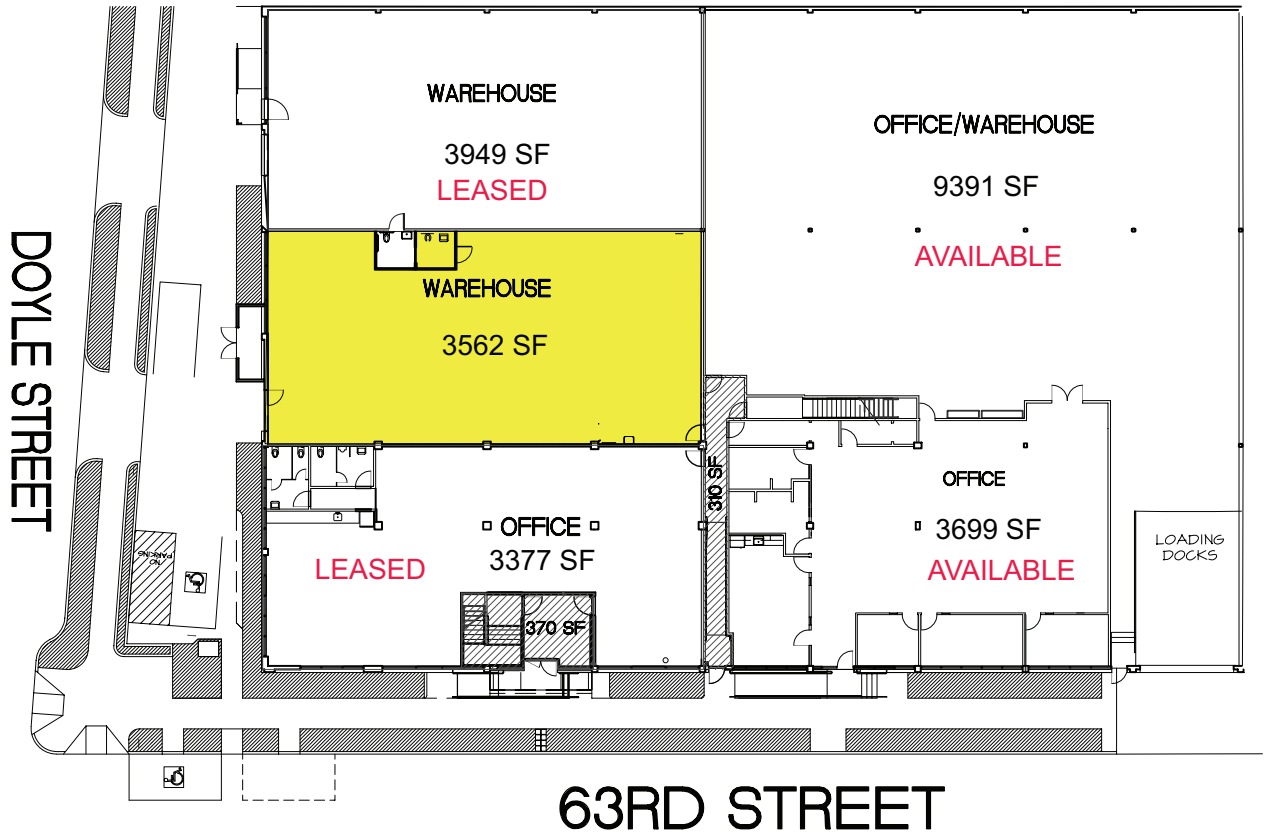

*For information, please contact:*

**Jim Clark**

Senior Managing Director

t 510-923-6247

jim.clark@ngkf.com

CA RE Lic #00926308

**Jeff Lahr**

Managing Director

t 510-923-6208

jlahr@ngkf.com

CA RE Lic #01296493

[nmrk.com](http://nmrk.com)

**NEWMARK**

The distributor of this communication is performing acts for which a real estate license is required. The information contained herein has been obtained from sources deemed reliable but has not been verified and no guarantee, warranty or representation, either express or implied, is made with respect to such information. Terms of sale or lease and availability are subject to change or withdrawal without notice.