

Northlake Gardens

3333 Northlake Boulevard, Palm Beach Gardens



Located on the northwest corner of Northlake Boulevard and Mac Arthur Boulevard in Palm Beach Gardens.

- Former cellular store for lease 2,000 square feet
- Benefits from combined traffic counts in excess of 61,000 VPD
- Grease Trap available for food uses

Join:



Demographics (3-mile radius)



Population:
89,592



Daytime Population:
72,068



Median Age:
42



Average Household
Income:
\$90,953

Alfredo Sanchez,
Associate
561 721 7027
alfredo.sanchez@avisonyoung.com

Brian Richardson
Principal
305 504 2047
brian.richardson@avisonyoung.com

312 Clematis Street
Suite 500
West Palm Beach, FL 33401
561 721 7000

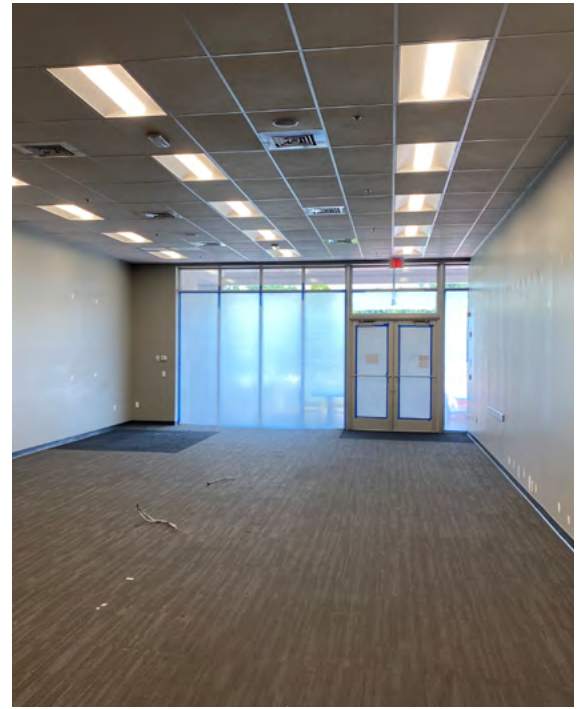
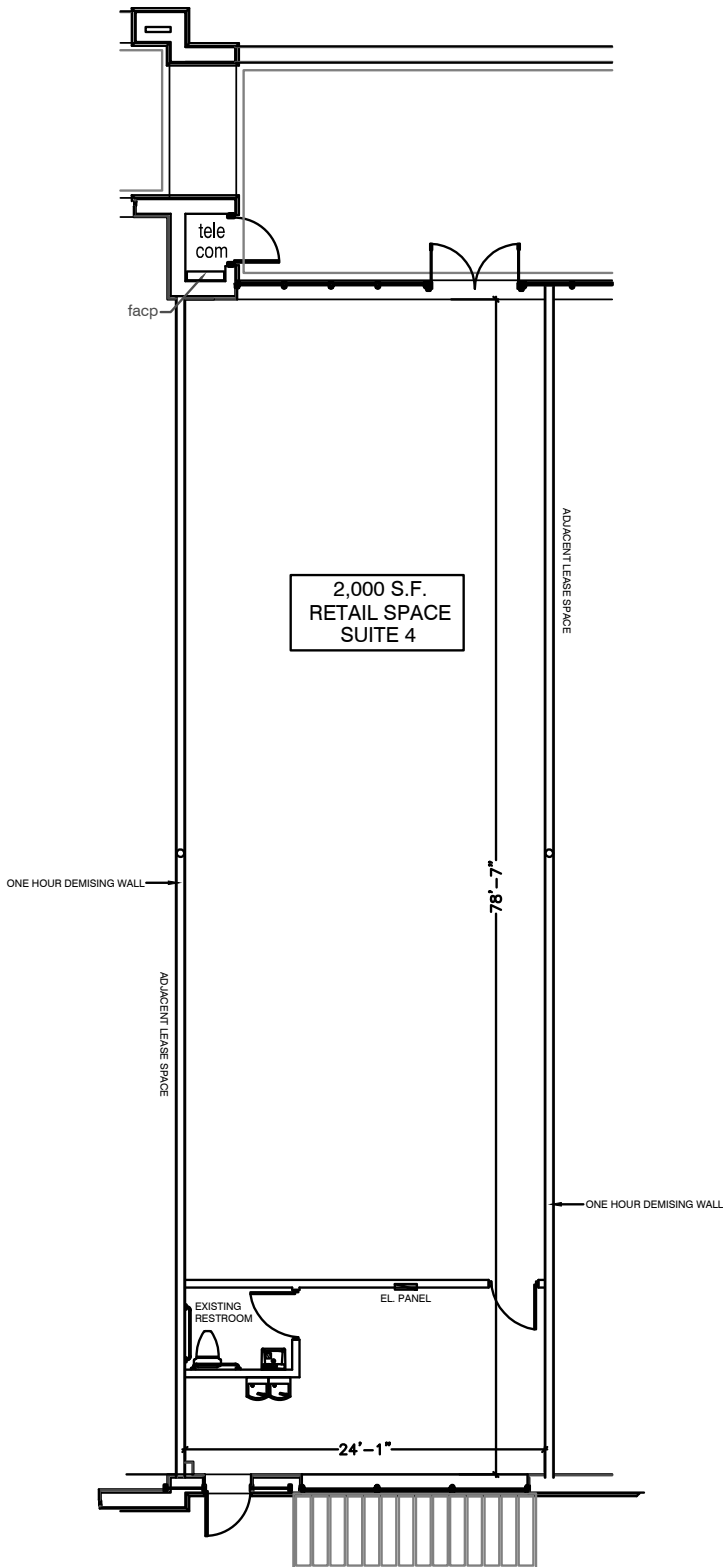

avisonyoung.com

Alfredo Sanchez
Associate
561 721 7027
alfredo.sanchez@avisonyoung.com

Brian Richardson
Principal
305 504 2047
brian.richardson@avisonyoung.com

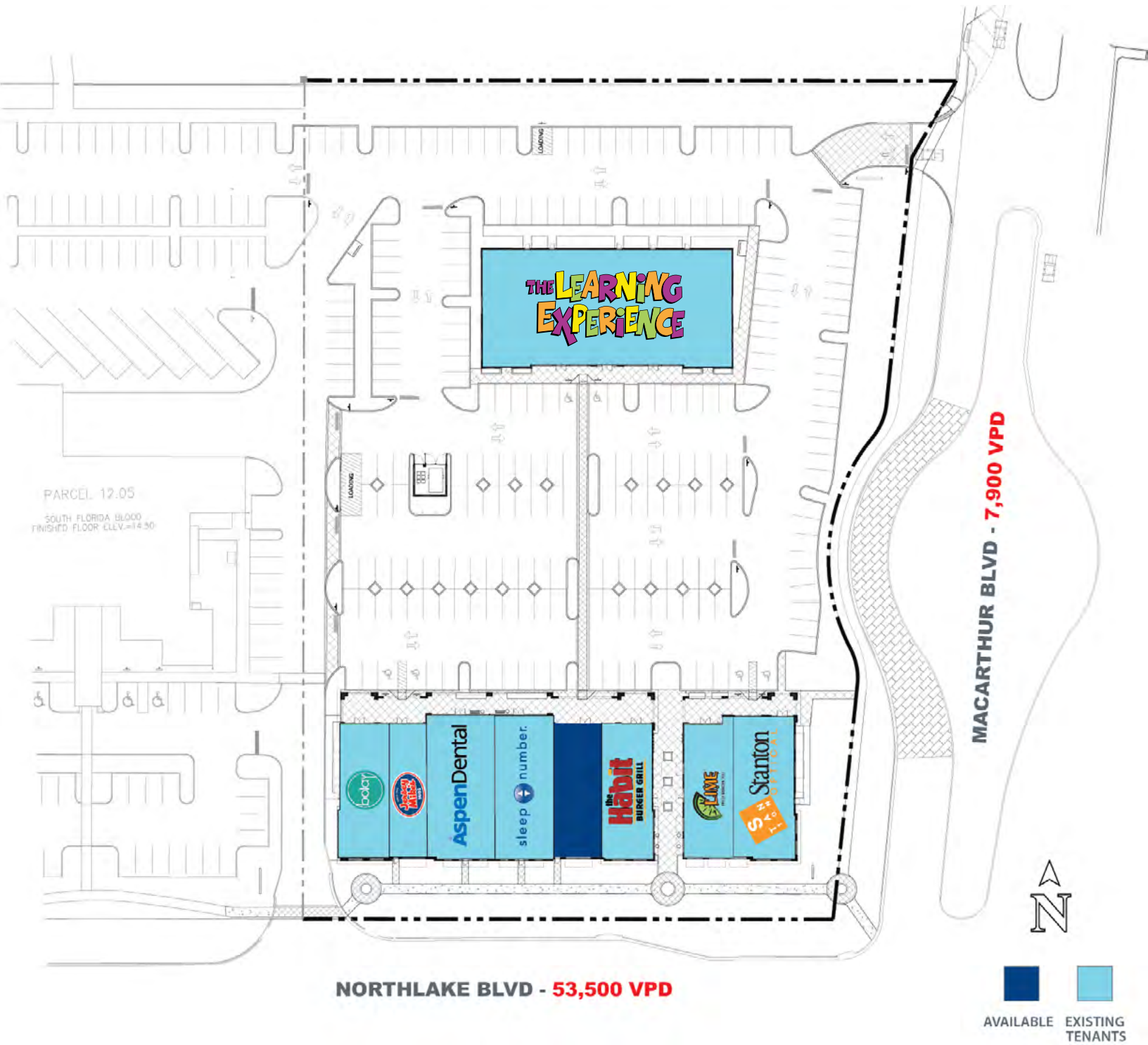

**AVISON
YOUNG**

avisonyoung.com

Alfredo Sanchez
Associate
561 721 7027
alfredo.sanchez@avisonyoung.com

Brian Richardson
Principal
305 504 2047
brian.richardson@avisonyoung.com

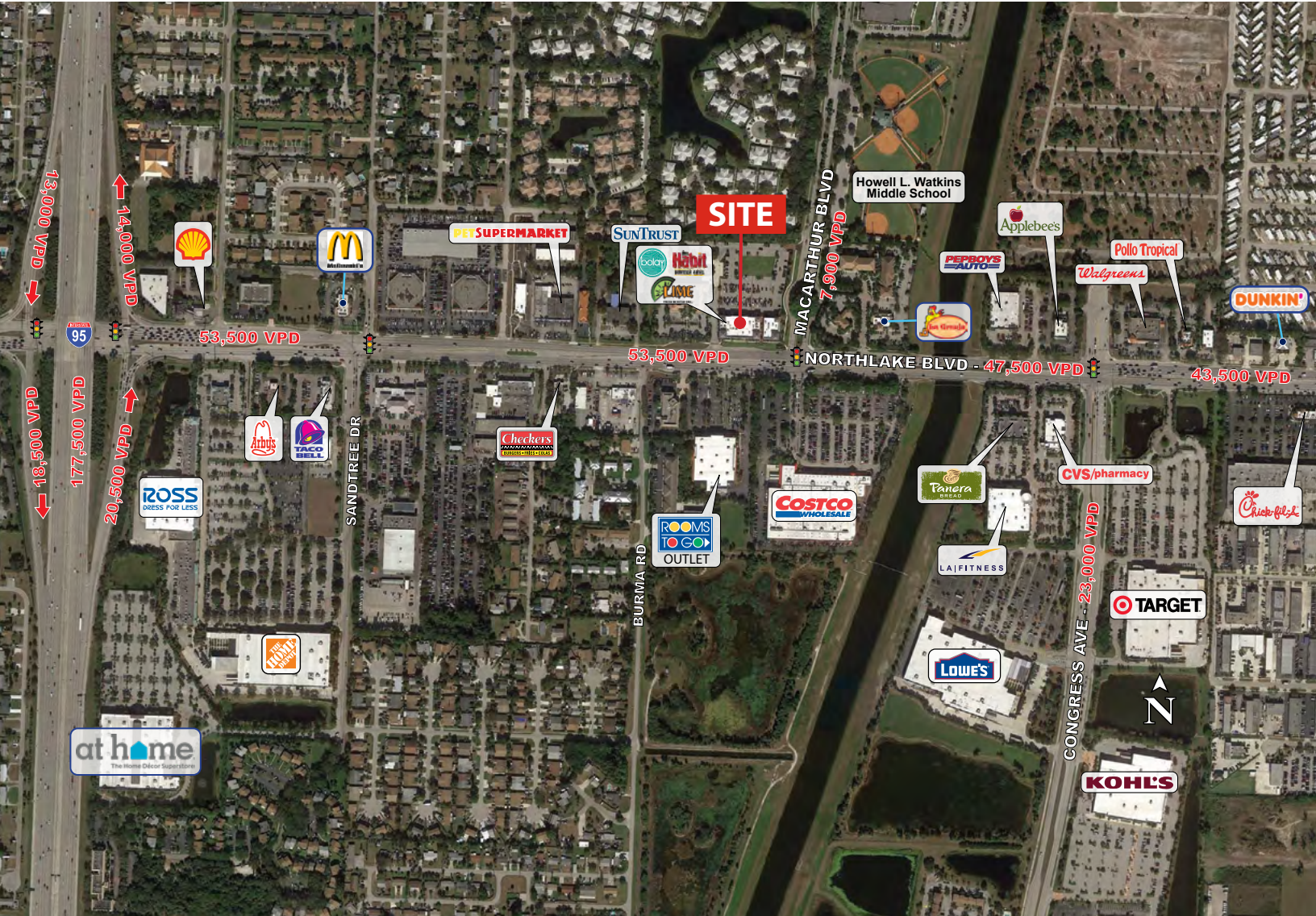

avisonyoung.com

Alfredo Sanchez

Associate

561 721 7027

alfredo.sanchez@avisonyoung.com

Brian Richardson

Principal

305 504 2047

brian.richardson@avisonyoung.com