

48-02 48TH AVENUE

Long Island City



FOR LEASE

143,600 SF Warehouse Plus 10,500 Parking

Divisions 10.5K / 15K / 20K / 37K



For Further Information and Inspection, Please Contact Exclusive Agents:

Joseph P. Meyerson
(718) 512-2620
joseph.meyerson@cushwake.com

Michael Deutsch
(914) 299-1302
michael.deutsch@cushwake.com

48-02 48TH AVENUE

Long Island City

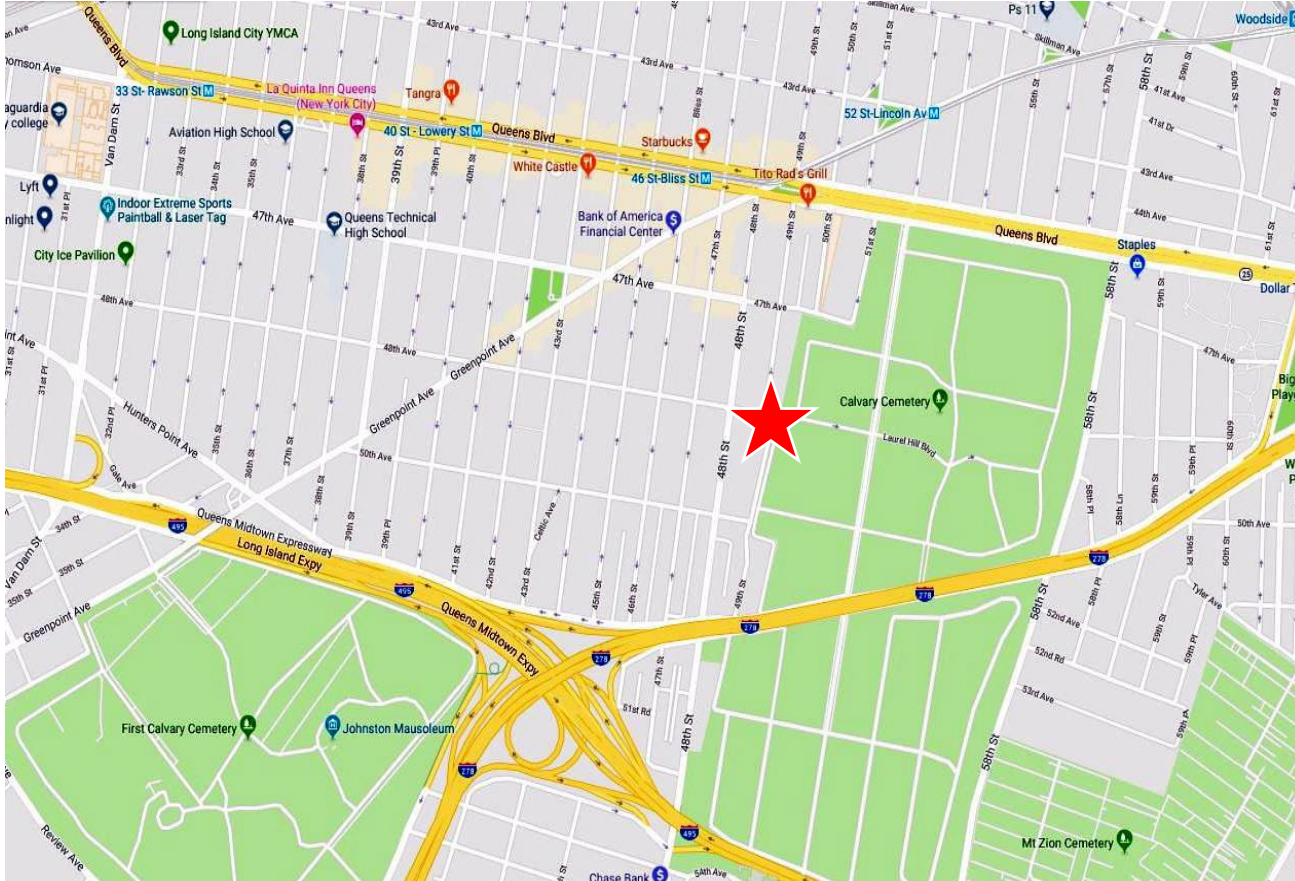

AVAILABLE
143,600 SF plus
10,500 SF Land

FEATURES:

- ❖ Divisible to 10,404 sf
- ❖ Fireproof – sprinklered
- ❖ 12' – 15' ceiling height
- ❖ 10 interior docks
- ❖ 2 drive-ins
- ❖ Heavy Amps; oil & gas heat
- ❖ Column spacing 30' X 30'
- ❖ 10,000 sf parking (30 cars)
- ❖ 3 mins to 7 train at 46 St. – Bliss St.
- ❖ Zone M1-1
- ❖ Block 2292 Lot 7

IDEAL FOR:

- E-Commerce distribution,
- Film & TV studio production
- Building material
- Warehouse, Mini-storage
- Food distribution
- Entertainment facility

For Further Information and Inspection, Please Contact Exclusive Agents:

Joseph P. Meyerson
(718) 512-2620
joseph.meyerson@cushwake.com

Michael Deutsch
(914) 299-1302
michael.deutsch@cushwake.com

48-02 48TH AVENUE

Long Island City



For Further Information and Inspection, Please Contact Exclusive Agents:

Joseph P. Meyerson
(718) 512-2620
joseph.meyerson@cushwake.com

Michael Deutsch
(914) 299-1302
michael.deutsch@cushwake.com

48-02 48TH AVENUE

Long Island City



FIRST FLOOR

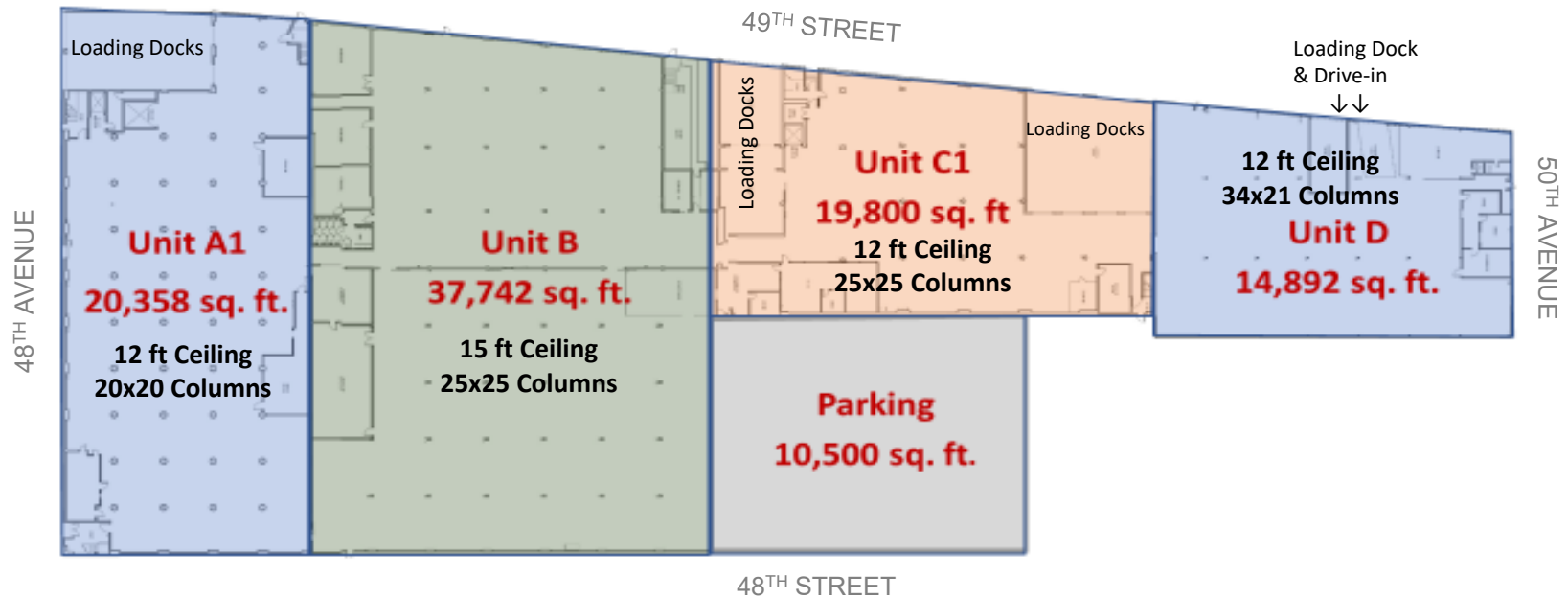

Unit B – Owner will configure docks to Tenant's request

For Further Information and Inspection, Please Contact Exclusive Agents:

Joseph P. Meyerson
(718) 512-2620
joseph.meyerson@cushwake.com

Michael Deutsch
(914) 299-1302
michael.deutsch@cushwake.com

48-02 48TH AVENUE

Long Island City



SECOND FLOOR

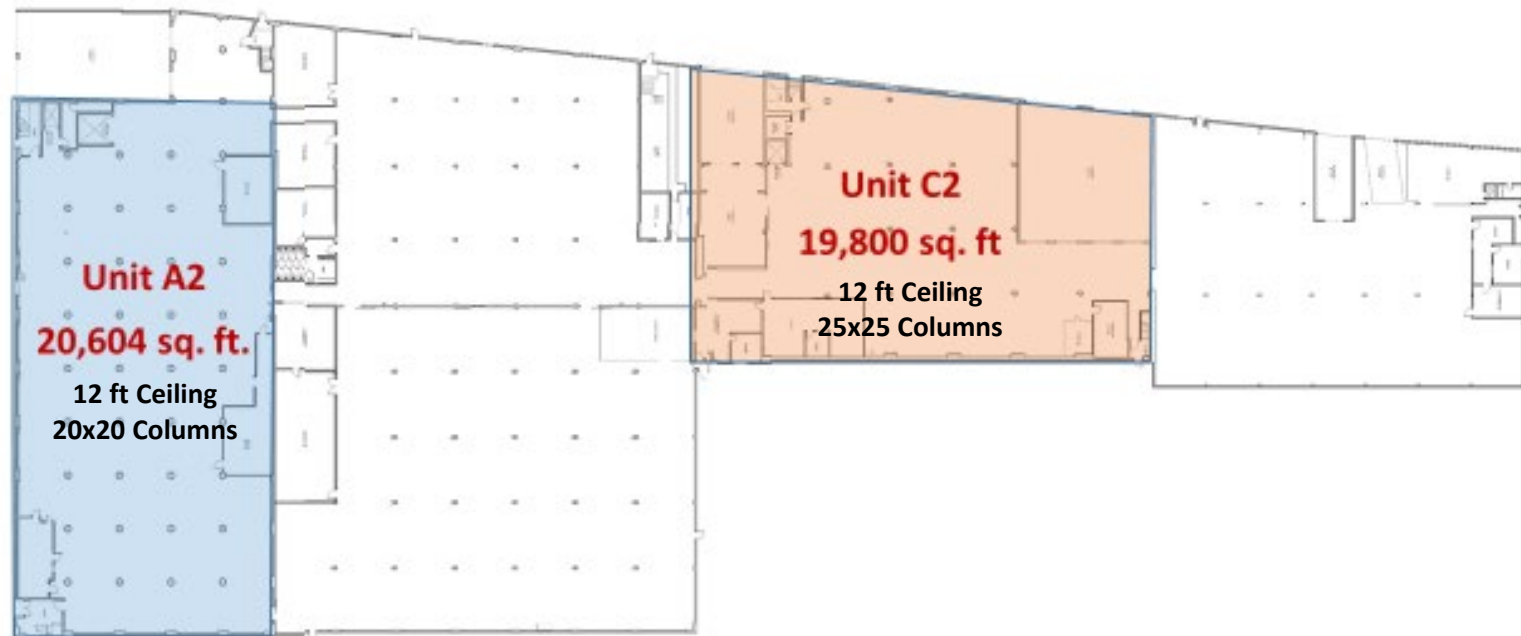

For Further Information and Inspection, Please Contact Exclusive Agents:

Joseph P. Meyerson
(718) 512-2620
joseph.meyerson@cushwake.com

Michael Deutsch
(914) 299-1302
michael.deutsch@cushwake.com

48-02 48TH AVENUE

Long Island City



THIRD FLOOR

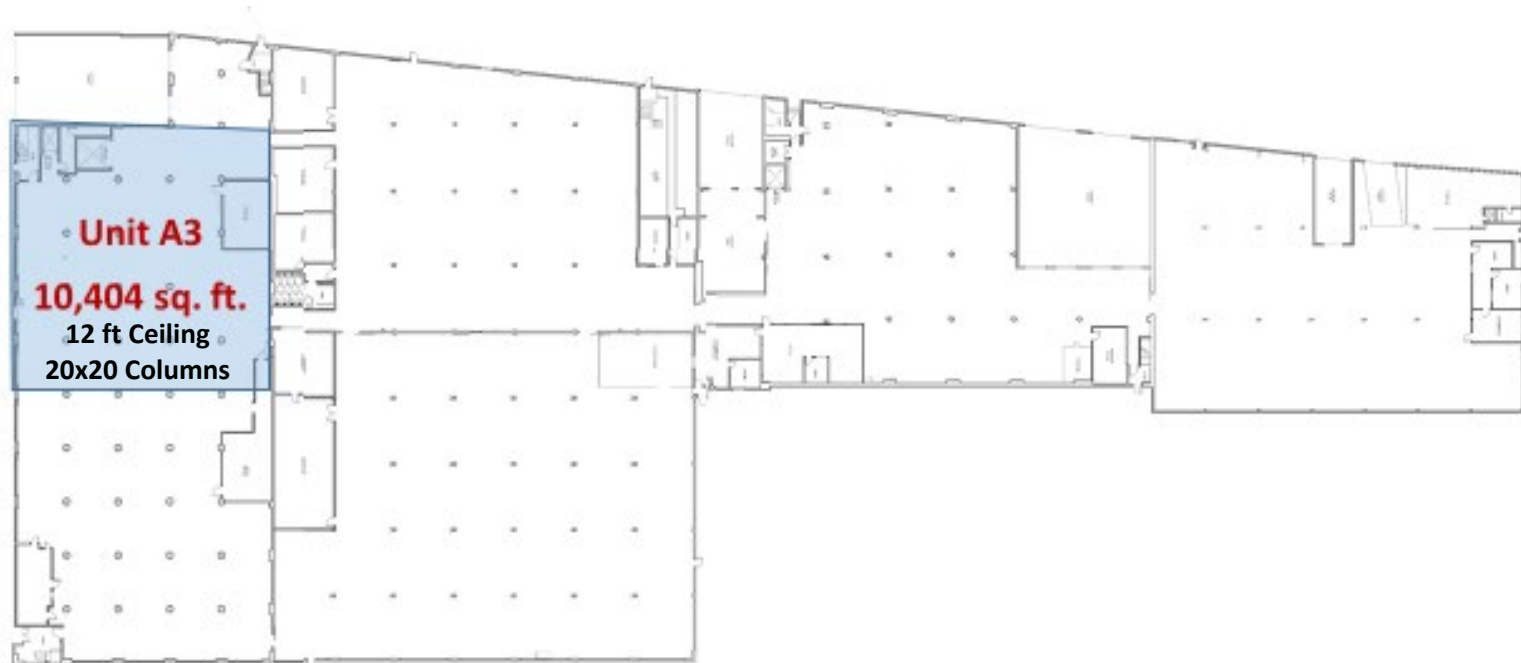

For Further Information and Inspection, Please Contact Exclusive Agents:

Joseph P. Meyerson
(718) 512-2620
joseph.meyerson@cushwake.com

Michael Deutsch
(914) 299-1302
michael.deutsch@cushwake.com